

PART NUMBER:  
190480

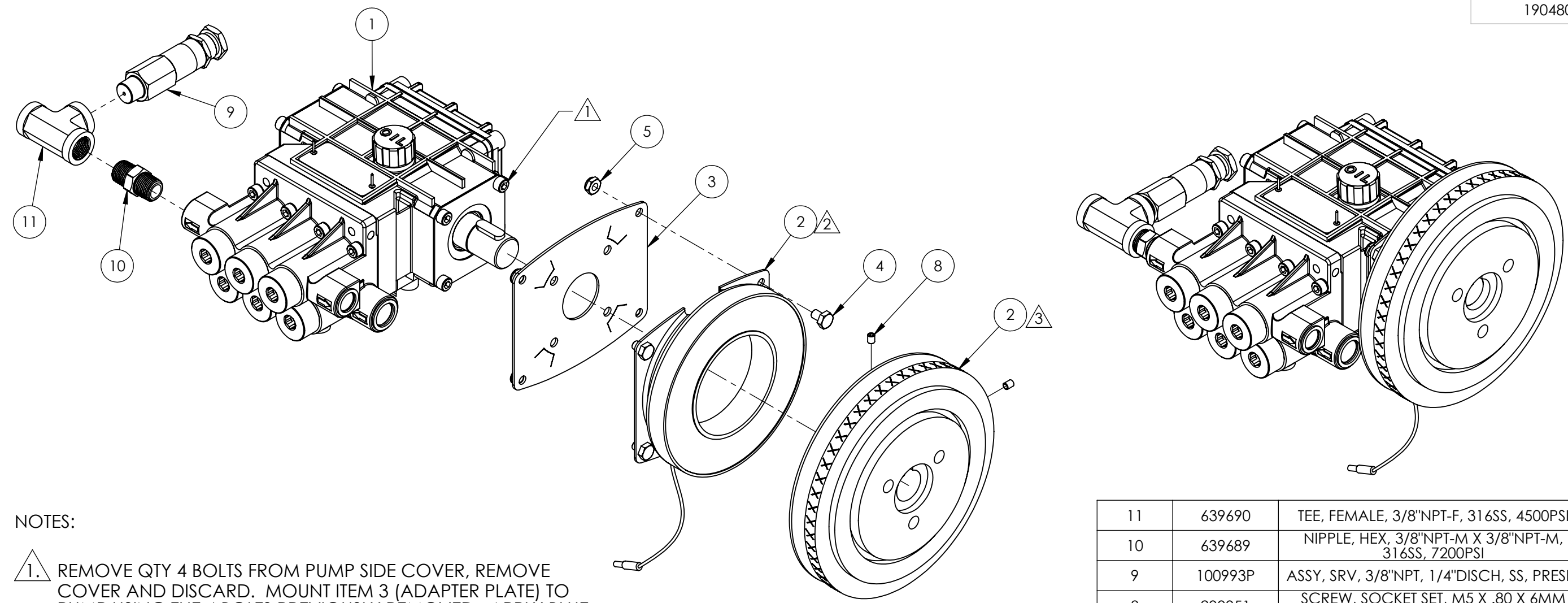

NOTES:

- 1. REMOVE QTY 4 BOLTS FROM PUMP SIDE COVER, REMOVE COVER AND DISCARD. MOUNT ITEM 3 (ADAPTER PLATE) TO PUMP USING THE 4 BOLTS PREVIOUSLY REMOVED. APPLY BLUE LOCTITE 243 OR EQUIVALENT TO THE THREADS OF OF THE 4 BOLTS AND TORQUE TO 10 FT/LBS MIN (REF.)
- 2. MOUNT CLUTCH COIL PORTION OF ITEM 2 (CLUTCH ASSEMBLY) TO ITEM 3 (ADAPTER PLATE) WITH ITEM 4 (1/4-28 SCREWS) AND ITEM 5 (NYLOCK NUTS). USE ALIGNMENT TOOL (GP P/N: 100163) TO ENSURE COIL IS CONCENTRIC TO PUMP SHAFT. TIGHTEN MOUNTING BOLTS UNTIL SECURED. NOTE: CLUTCH WIRE TO BE ORIENTED TO THE BOTTOM OF THE PUMP
- 3. MOUNT CLUTCH PULLEY TO PUMP SHAFT USING SET SCREWS (ITEM 8). APPLY LOCTITE 243 OR EQUIVALENT, TORQUE TO 50 IN/LBS (REF.)
- 4. ITEMS 6 (SPEC SHEET) AND 7 (LABEL) ARE NOT SHOWN IN DRAWING- APPLY ITEM 7 (LABEL) AS NEEDED AND INCLUDE ITEM 6 (SPEC SHEET) WITH FINAL ASSEMBLY
- 5. INCLUDE PUMP RAILS WITH FINAL ASSEMBLY FOR SHIPMENT- DO NOT INSTALL
- 6. PRESET SRV (ITEM 9) TO POP-OFF AT 950 PSI

ITEM NO.	PART NUMBER	DESCRIPTION	QTY.	U/M
11	639690	TEE, FEMALE, 3/8"NPT-F, 316SS, 4500PSI	1	EA
10	639689	NIPPLE, HEX, 3/8"NPT-M X 3/8"NPT-M, 316SS, 7200PSI	1	EA
9	100993P	ASSY, SRV, 3/8"NPT, 1/4"DISCH, SS, PRESET	1	EA
8	200051	SCREW, SOCKET SET, M5 X .80 X 6MM KNURLED CUP POINT	2	EA
7	604000	LABEL, 1X3 THERMAL, TRANSFER	1	AR
6	300189	SPEC SHT, CLUTCH FOR 24MM SOLID SHAFT	1	AR
5	203201	NYLON INSERT JAM NUT, 1/4-28 UNF	4	EA
4	201004	HHCS, 1/4-28 X 3/8	4	EA
3	540048	ADAPTER PLATE, 50 SERIES	1	EA
2	103048	CLUTCH, SINGLE GROOVE, 7", 12V, 24mm	1	EA
1	WM4215S	PUMP, WM SERIES, 4.2 GPM, SOLID SHAFT	1	EA

REV	ECR #	DESCRIPTION	INITIALS	DATE
C	14-044	REPLACED 100993 WITH 100993P; CHANGE NOTE 6, SRV WAS PRESET TO 1,000 PSI	SWJ	3/13/2014
B	13-161	ADD ITEMS 9 - 11 (SRV, TEE, NIPPLE); ADD PRESET NOTE 6	SWJ	9/16/2013
A	12-154	RELEASED FOR PRODUCTION	SWJ	11/27/2012
REVISIONS				

**GP COMPANIES INC.**  
1174 Northland Dr.  
Mendota Heights MN 55120  
PHONE: (651) 454-6500  
FAX: (651) 454-8015

**UNLESS OTHERWISE SPECIFIED:**  
DIMENSIONS ARE IN INCHES  
(DUAL DIMENSIONS ARE IN MILLIMETERS)

SURFACE FINISH: 125 ✓  
FRACTIONAL: ± 1/64  
ANGULAR: ± 1°  
ONE PLACE DECIMAL: ± 0.05  
TWO PLACE DECIMAL: ± 0.01  
THREE PLACE DECIMAL: ± 0.005  
REMOVE ALL BURRS AND BREAK SHARP EDGES .010 MAX

REPLACES PART NUMBER: N/A  
REV: N/A

DRAWN BY: SWJ DATE: 11/27/12  
CHK'D BY: DATE:  
APP'D BY: DATE:

**PROPRIETARY AND CONFIDENTIAL**  
THE INFORMATION CONTAINED IN THIS DRAWING IS PROPRIETARY AND MAY CONTAIN TRADE SECRETS AND PATENTABLE SUBJECT MATTER WHICH ARE THE EXCLUSIVE PROPERTY OF GP COMPANIES INC. THIS DRAWING IS PROTECTED BY THE COPYRIGHT LAWS OF THE UNITED STATES. ALL UNAUTHORIZED COPYING IS PUNISHABLE BY FINE OR IMPRISONMENT.  
© 2009 GP CO., INC.

INTERPRET GEOMETRIC TOLERANCING PER: ASME Y14.5-2009

SURFACE TREATMENT: N/A

HEAT TREATMENT: N/A

MATERIAL: SEE BOM

DESCRIPTION: ASSY, WM4215S, SNGL GRV CLUTCH, 12V

SHEET NUMBER: 1:1

SCALE: 1:3

WEIGHT: 20.96 #

DO NOT SCALE DRAWING

DRAWING SIZE: **B** PART NUMBER: 190480  
REV: **C**